

CUSTOM METRIC ROD END CLEVIS

NORTH AMERICAN AUTOMOTIVE METRIC STANDARDS

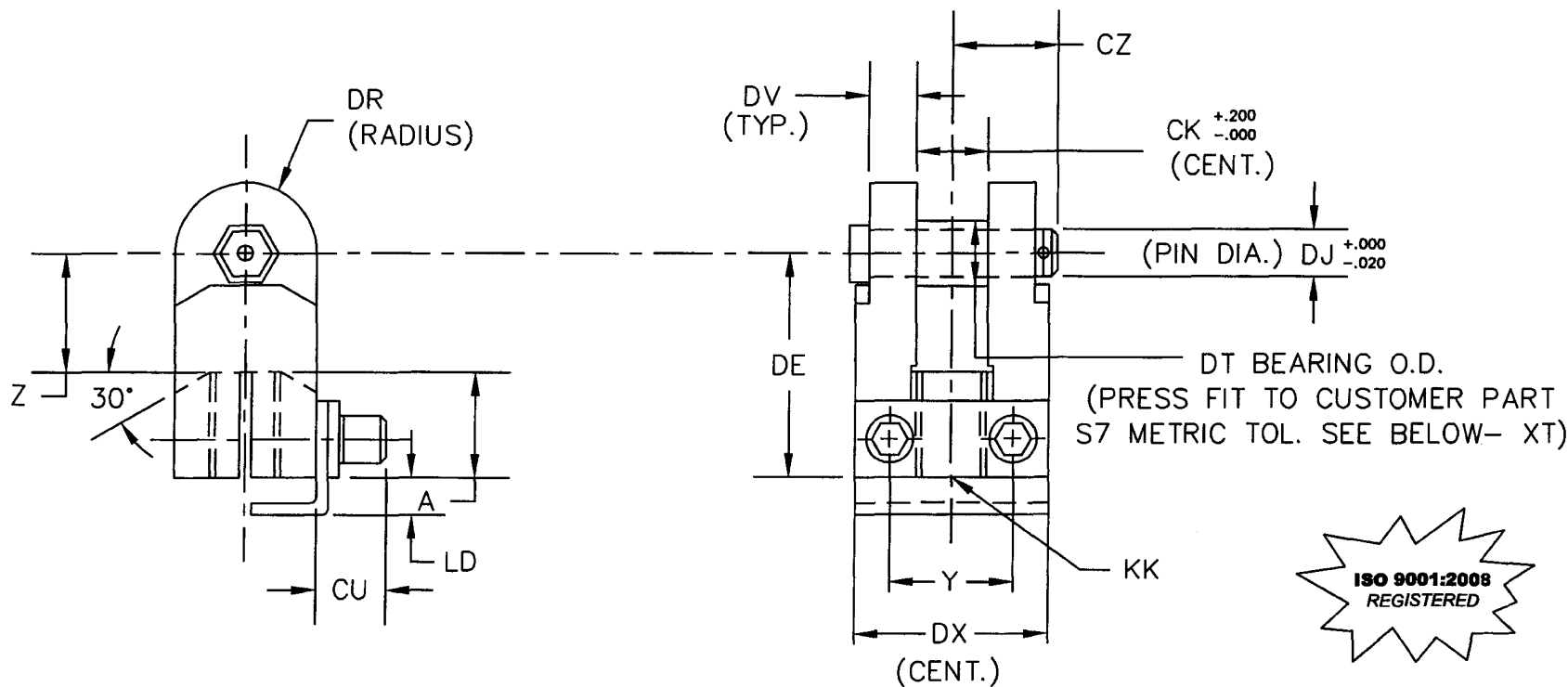

| NAAM'S CODE | CYL. BORE | ORDER NUMBER | KK | A | CK | CU | CZ | DE | DJ | DR | DT | DV | DX | LD | XZ | Y | Z |
|-------------|-----------|--------------|------------|------|------|------|------|------|------|------|---------------|------|------|------|---------------|------|------|
| A630310 | 32 | IF1150-63 | M10 x 1.25 | 19.0 | 20.0 | 18.0 | 28.0 | 38.0 | 12.0 | 13.0 | 17.068/17.043 | 12.0 | 45.0 | 8.0 | 17.000/17.018 | 26.9 | 19.0 |
| A630412 | 40 | IF1150-64 | M12 x 1.25 | 19.0 | 20.0 | 18.0 | 28.0 | 38.0 | 12.0 | 13.0 | 17.068/17.043 | 12.0 | 45.0 | 8.0 | 17.000/17.018 | 26.9 | 19.0 |
| A630516 | 50 & 63 | IF1200-73 | M16 x 1.5 | 29.0 | 20.0 | 20.0 | 30.0 | 60.0 | 15.0 | 19.0 | 20.071/20.046 | 12.0 | 53.0 | 10.0 | 20.000/20.021 | 35 | 31.0 |
| A630820 | 80 & 100 | IF1400-73 | M20 x 1.5 | 40.0 | 32.0 | 20.0 | 39.0 | 80.0 | 20.0 | 25.0 | 25.096/25.046 | 15.0 | 64.0 | 12.0 | 25.000/25.021 | 44.5 | 40.0 |
| A631227 | 125 | IF1400-63 | M27 x 2.0 | 42.0 | 38.0 | 20.0 | 43.0 | 80.0 | 25.0 | 25.0 | 30.100/30.050 | 19.0 | 76.0 | 14.0 | 30.000/30.025 | 44.5 | 38.0 |
| A631636 | 160 | IF1400-64 | M36 x 2.0 | 42.0 | 38.0 | 20.0 | 43.0 | 80.0 | 25.0 | 25.0 | 30.100/30.050 | 19.0 | 76.0 | 14.0 | 30.000/30.025 | 46 | 38.0 |

PENINSULAR® CYLINDER COMPANY

METRIC

27650 Groesbeck Highway Roseville Michigan 48066-2759 Telephone: 586-775-7211 Fax: 586-775-4545

9.00

REV. 02/09/2010