

CAP TRUNNION

PENINSULAR® CYLINDER COMPANY

METRIC HIGH PRESSURE HYDRAULIC CYLINDER
 LARGE BORE SERIES – ISO 6020-3
 WORKING PRESSURE – 160 BAR (2320 PSI)
 RATED PRESSURE – 250 BAR (3625 PSI)

NOTE:
 FOR OTHER ROD END THREADS, REFER TO THE HOW TO ORDER SERIES IHP HIGH PRESSURE HYDRAULIC CYLINDERS (LARGE BORE SERIES) INFORMATION GUIDE.
 FOR SENSING OPTIONS CONTACT PENINSULAR.
 *FOR PORT AND CUSHION POSITIONS, REFER TO THE HOW TO ORDER SERIES IHP HIGH PRESSURE HYDRAULIC CYLINDERS (LARGE BORE SERIES) INFORMATION GUIDE.

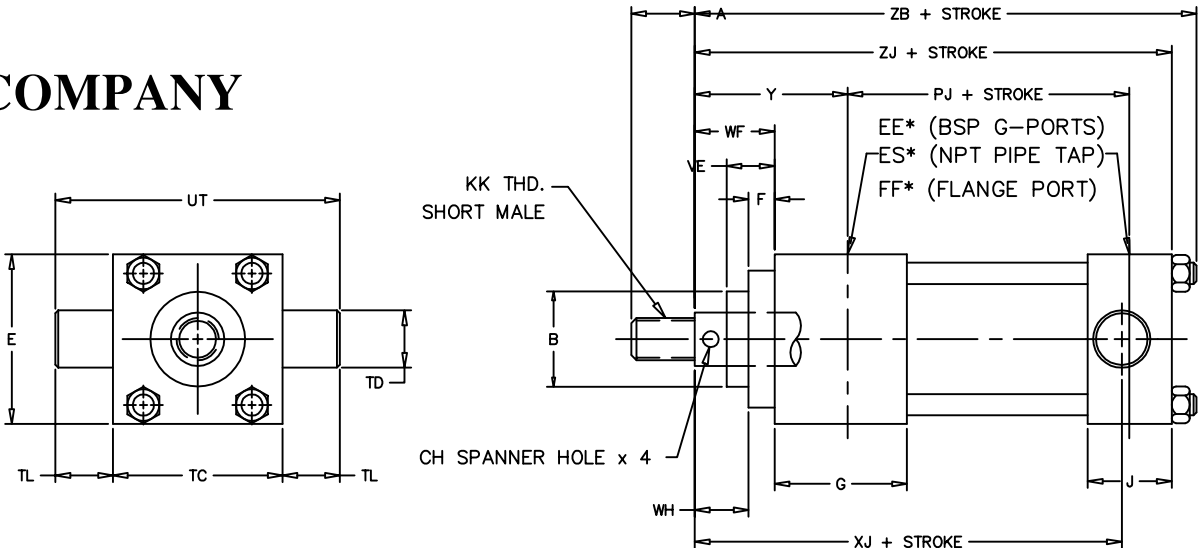

PENINSULAR "M" STYLE SHOWN										DIMENSIONS IN MILLIMETERS														
BORE SIZE	ROD DIAMETER	KK THD. SHORT MALE					G PORT	NPT (INCHES)	FLANGE PORT															
			A	B f9	CH	E	EE	ES	FF **	F	G	J	PJ	TC	TD f8	TL	UT	VE	WF	WH	XJ	Y	ZB	ZJ
250	140.0	M100 x 3	112.0	163.0	15.0	320.0	1 1/2"	2"	DN 51	25.0	134.0	94.0	216.0	320.0	125.0	100.0	520.0	83.0	110.0	85.0	393.0	157.0	491.0	460.0
	160.0	M110 x 3	112.0	185.0																				
	180.0	M125 x 4	125.0	205.0																				
320	180.0	M125 x 4	125.0	205.0	15.0	400.0	1 1/2"	2 1/2"	DN 64	35.0	170.0	114.0	251.0	400.0	160.0	125.0	650.0	83.0	110.0	75.0	450.0	167.0	569.0	535.0
	200.0	M140 x 4	140.0	225.0																				
	220.0	M160 x 4	160.0	245.0																				
360	180.0	M125 x 4	125.0	205.0	15.0	450.0	2"	2 1/2"	DN 64	42.0	190.0	124.0	296.0	450.0	180.0	145.0	740.0	83.0	110.0	68.0	500.0	172.0	629.0	595.0
	220.0	M160 x 4	160.0	245.0																				
	250.0	M180 x 4	180.0	275.0																				
400	220.0	M160 x 4	160.0	245.0	15.0	500.0	2"	2 1/2"	DN 64	50.0	205.0	150.0	320.0	500.0	200.0	160.0	820.0	83.0	110.0	60.0	525.0	185.0	667.0	628.0
	250.0	M180 x 4	180.0	275.0																				
	280.0	M200 x 4	200.0	305.0																				
500	280.0	M200 x 4	200.0	305.0	15.0	630.0	2"	2 1/2"	DN 64	70.0	254.0	200.0	400.0	630.0	250.0	200.0	1030.0	83.0	110.0	40.0	615.0	210.0	792.0	792.0
	320.0	M220 x 4	220.0	345.0																				
	360.0	M250 x 6	250.0	385.0																				

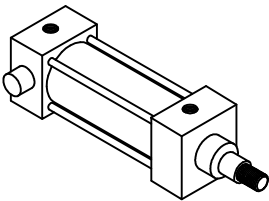

IHP 7 (MT2)

** PER ISO 6162 ISO 6020-3