

PIVOT PIN - FOR SPHERICAL PLAIN BEARING LOCKING PLATE TYPE

PENINSULAR[®] CYLINDER COMPANY

METRIC HIGH PRESSURE HYDRAULIC CYLINDER ACCESSORIES
SMALL BORE SERIES - ISO 6020-2
WORKING PRESSURE - 160 BAR (2320 PSI)
RATED PRESSURE - 250 BAR (3625 PSI)

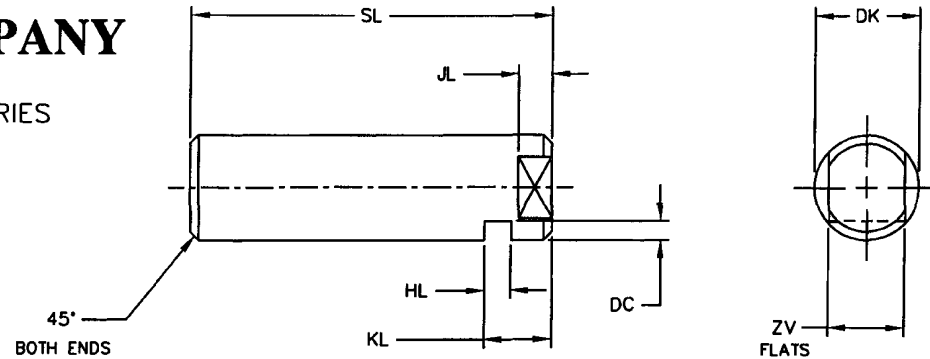

DIMENSIONS IN MILLIMETERS

ORDER NUMBER	TYPICAL BORE DIAMETER	NOMINAL FORCE (N)	DC	DK H6	HL +0.2 -0.0	JL	KL	SL	ZV	ZX	WEIGHT (KG)
IHP12-72PL	25	8 000	4.0	12.0	3.3	4.5	8.0	40.0	10.0	1.0	0.035
IHP16-72PL	32	12 500	4.0	16.0	3.3	5.5	8.0	50.0	13.0	1.0	0.075
IHP20-72PL	40	20 000	5.0	20.0	4.5	5.5	10.0	62.0	17.0	1.5	0.150
IHP25-72PL	50	32 000	5.0	25.0	4.5	5.5	10.0	72.0	22.0	1.5	0.270
IHP30-72PL	63	50 000	6.0	30.0	5.5	7.5	13.0	85.0	24.0	2.0	0.410
IHP40-72PL	80	80 000	7.0	40.0	6.5	9.5	16.0	100.0	32.0	2.0	0.950
IHP50-72PL	100	125 000	8.0	50.0	9.0	10.0	19.0	122.0	41.0	2.0	1.710
IHP60-72PL	125	200 000	9.0	60.0	9.0	11.0	20.0	145.0	50.0	2.0	3.130
IHP80-72PL	160	320 000	11.0	80.0	11.0	15.0	26.0	190.0	70.0	3.0	7.140
IHP100-72PL	200	500 000	14.0	100.0	13.0	15.0	30.0	235.0	90.0	3.0	14.40



ACCESSORY MOUNTING DIMENSIONS CONFORM TO ISO 8133
ACCESSORIES ARE DESIGNED FOR, BUT NOT LIMITED TO, ISO 6020-2 HYDRAULIC CYLINDERS

27650 Groesbeck Highway Roseville Michigan 48066-2759 Telephone: 586-775-7211 Fax: 586-775-4545
Toll Free: 800-526-7968 Internet: <http://www.peninsularcylinders.com> Email: sales@peninsularcylinders.com