

# CAP TRUNNION PENINSULAR® CYLINDER COMPANY

METRIC HIGH PRESSURE HYDRAULIC CYLINDER  
LARGE BORE SERIES – ISO 6020-3  
WORKING PRESSURE – 160 BAR (2320 PSI)  
RATED PRESSURE – 250 BAR (3625 PSI)

NOTE:  
FOR OTHER ROD END THREADS, REFER TO THE HOW TO ORDER SERIES IHP HIGH PRESSURE HYDRAULIC CYLINDERS (LARGE BORE SERIES) INFORMATION GUIDE.  
FOR SENSING OPTIONS CONTACT PENINSULAR.  
\*FOR PORT AND CUSHION POSITIONS, REFER TO THE HOW TO ORDER SERIES IHP HIGH PRESSURE HYDRAULIC CYLINDERS (LARGE BORE SERIES) INFORMATION GUIDE.

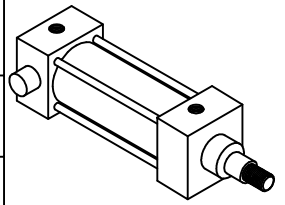
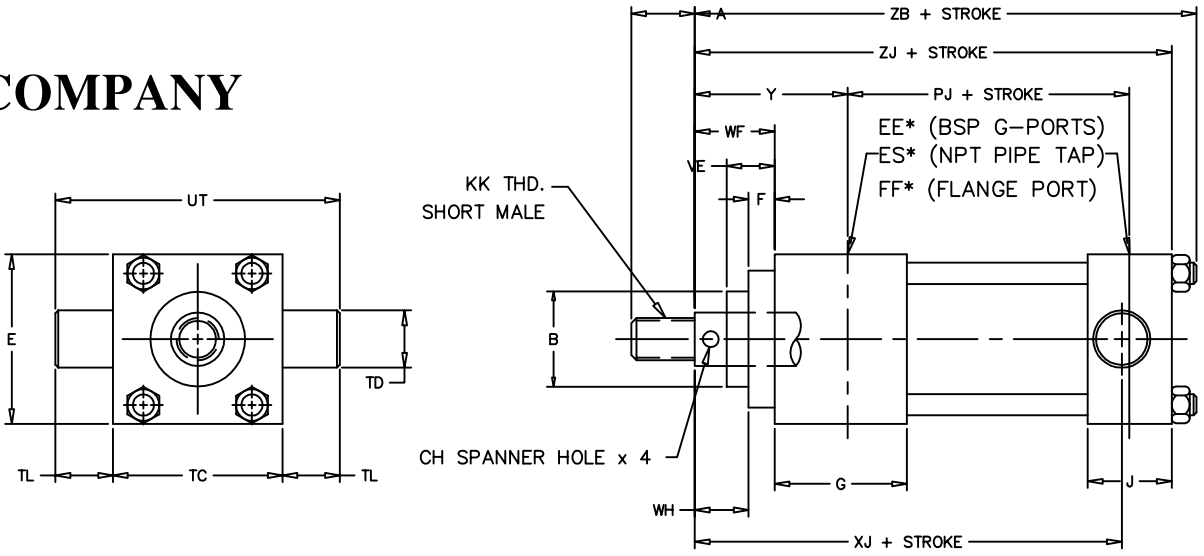

**IHP 7 (MT2)**

PENINSULAR "M" STYLE SHOWN			DIMENSIONS IN MILLIMETERS																						
BORE SIZE	ROD DIAMETER	KK THD. SHORT MALE	A	B f9	CH	E	G PORT	NPT (INCHES)	FLANGE PORT	FF **	F	G	J	PJ	TC	TD f8	TL	UT	VE	WF	WH	XJ	Y	ZB	ZJ
250	140.0	M100 x 3	112.0	163.0	15.0	320.0	1 1/2"	2"	DN 51	25.0	134.0	94.0	216.0	320.0	125.0	100.0	520.0	83.0	110.0	85.0	393.0	157.0	491.0	460.0	
	160.0	M110 x 3	112.0	185.0																					
	180.0	M125 x 4	125.0	205.0																					
320	180.0	M125 x 4	125.0	205.0	15.0	400.0	1 1/2"	2 1/2"	DN 64	35.0	170.0	114.0	251.0	400.0	160.0	125.0	650.0	83.0	110.0	75.0	450.0	167.0	569.0	535.0	
	200.0	M140 x 4	140.0	225.0																					
	220.0	M160 x 4	160.0	245.0																					
360	180.0	M125 x 4	125.0	205.0	15.0	450.0	2"	2 1/2"	DN 64	42.0	190.0	124.0	296.0	450.0	180.0	145.0	740.0	83.0	110.0	68.0	500.0	172.0	629.0	595.0	
	220.0	M160 x 4	160.0	245.0																					
	250.0	M180 x 4	180.0	275.0																					
400	220.0	M160 x 4	160.0	245.0	15.0	500.0	2"	2 1/2"	DN 64	50.0	205.0	150.0	320.0	500.0	200.0	160.0	820.0	83.0	110.0	60.0	525.0	185.0	667.0	628.0	
	250.0	M180 x 4	180.0	275.0																					
	280.0	M200 x 4	200.0	305.0																					
500	280.0	M200 x 4	200.0	305.0	15.0	630.0	2"	2 1/2"	DN 64	70.0	254.0	200.0	400.0	630.0	250.0	200.0	1030.0	83.0	110.0	40.0	615.0	210.0	792.0	792.0	
	320.0	M220 x 4	220.0	345.0																					
	360.0	M250 x 6	250.0	385.0																					

\*\* PER ISO 6162 ISO 6020-3